

The logo for bidoya.com features the word "bidoya" in a bold, rounded, lowercase font. The letters "bi", "do", and "ya" are white with a dark grey outline, while the letter "o" is a solid lime green. To the right of "bidoya" is ".com" in a smaller, dark grey, sans-serif font. The background of the entire page is a stylized city skyline with various skyscrapers in shades of green and grey.

bidoya
.com

an initiative of iCOREts

Seller Registration Guide

The registration process on bidoya.com is fairly easy and very user-friendly. Since bidoya.com is a serious online B2B marketplace it is important to fill Registration Form, to start promoting your products to Pre-Scanned and Legitimate Corporate Buyers. The Registration Form covers all the details required by any Corporate Buyer for smooth empaneling and Vendor Registration at their end.

2 quick steps to Register:

1. Create a Seller Account on www.bidoya.com
2. Complete the Registration Form

Account Creation:

Log onto www.bidoya.com and Register as a Seller.

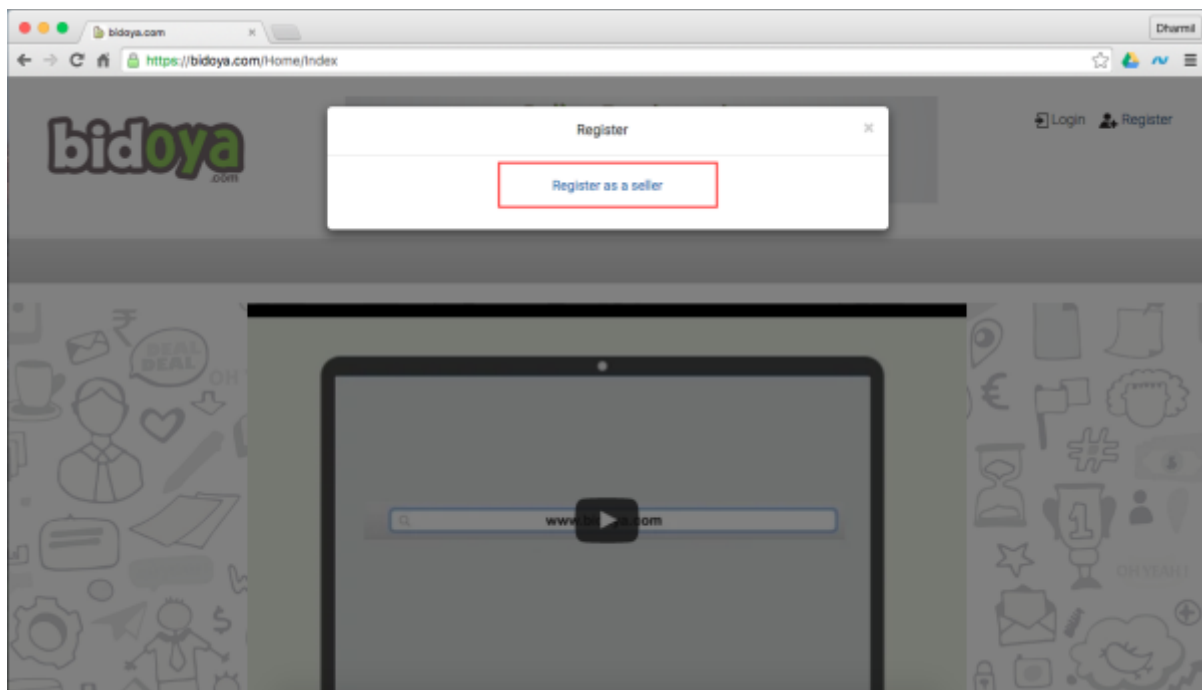

After creating the account click on the Verify Email button from your registered email.



Greetings!!!

Thank You for registering with bidoya. As a first step please click on the button below to verify your email.



Post that our team will verify your account details and get back to you. Please ignore this link if you have not registered with bidoya. Please feel free to contact us in case of any query.

Email id: info@bdioya.com

Contact No: +91 9769503254

Complete the Seller Registration Form by logging in with your registered email id and password.

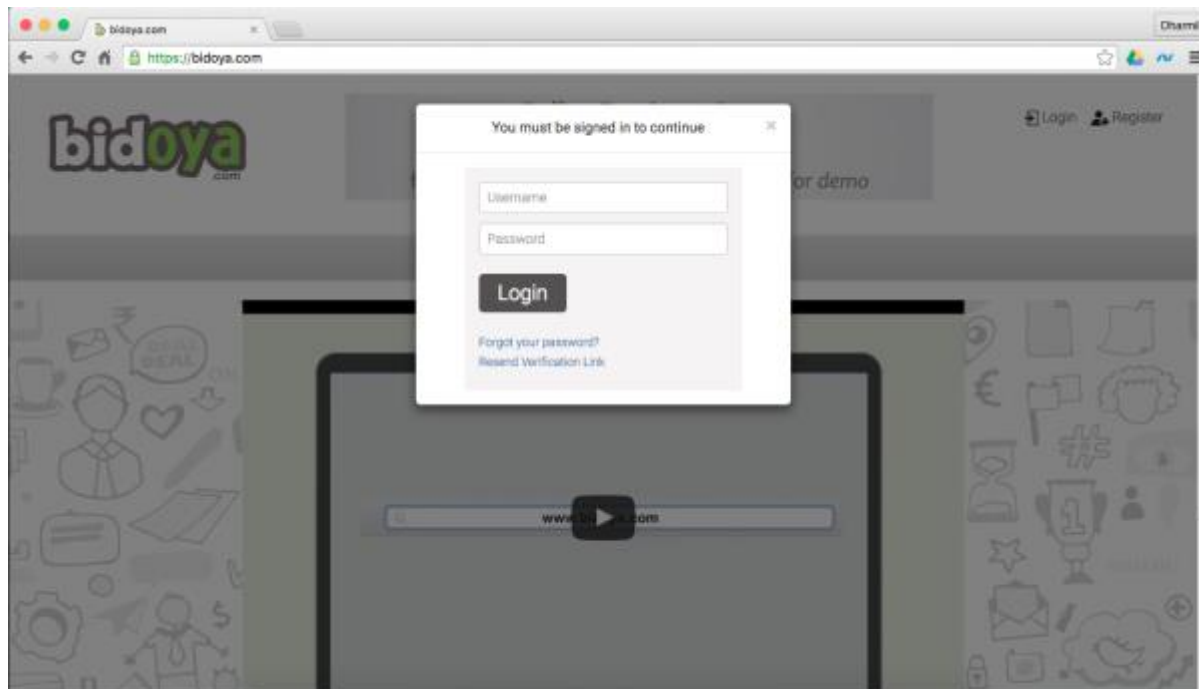

The Registration Form will cover the following points:

1. Personal Information
2. Company Information
3. Vat Details
4. Address
5. Bank Details
6. Seller Credibility (Optional)
7. Service Tax and Excise Details (Optional)
8. Seller Agreement & Seller Undertaking

Once you click on Submit your Registration Form will be submitted and our backend team will verify all the information.

Thank You for Registering!